

FOR SALE

13,756 SF



1126-1136 N. Fountain Way | Anaheim, CA
(Tustin Ave. and La Palma Ave.)

Features:

- Divisible/2 Buildings/2 Separate Parcels
- Office Space To Suit
- Office and Warehouse Restrooms
- 2 Power Panels: 400 Amps /200 Amps (Verify)
- 17-18' Warehouse Clear Height
- Large Paved and Fenced Yard
- 2:1 Car Parking
- Seven (7) Ground Level Doors
- 29,080 SqFt Lot (.67 Acres)
- Industrial Zoned (I-L), verify use with City
- Excellent Access to 91, 55, 57 Freeways

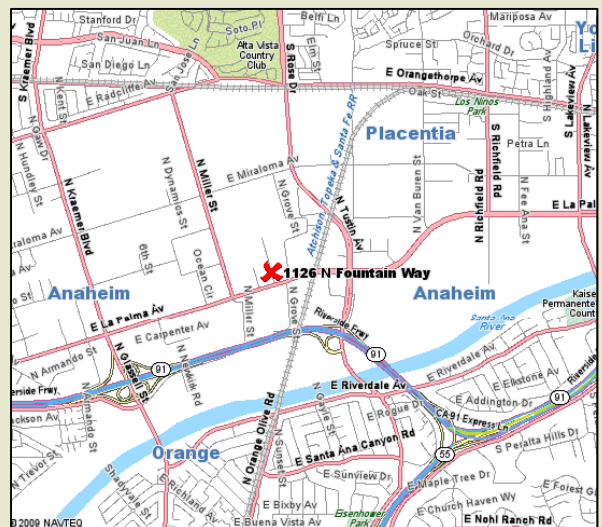

Chris Migliori

714.385.1801 x-3020

chris.migliori@daumcommercial.com
CA License #00972843

Paul Gingrich

714.385.1801 x-3033

paul.gingrich@daumcommercial.com
CA License #01299770

DAUM

COMMERCIAL REAL ESTATE SERVICES

D/AQ Corp #01192558

Although all information is furnished regarding for sale, rental or financing is from sources deemed reliable, such information has not been verified and no express representation is made nor is any to be implied as to the accuracy thereof, and it is submitted subject to errors, omissions, changes of price, rental or other conditions, prior sale, lease or financing, or withdrawal without notice.

FOR SALE

13,756 SF

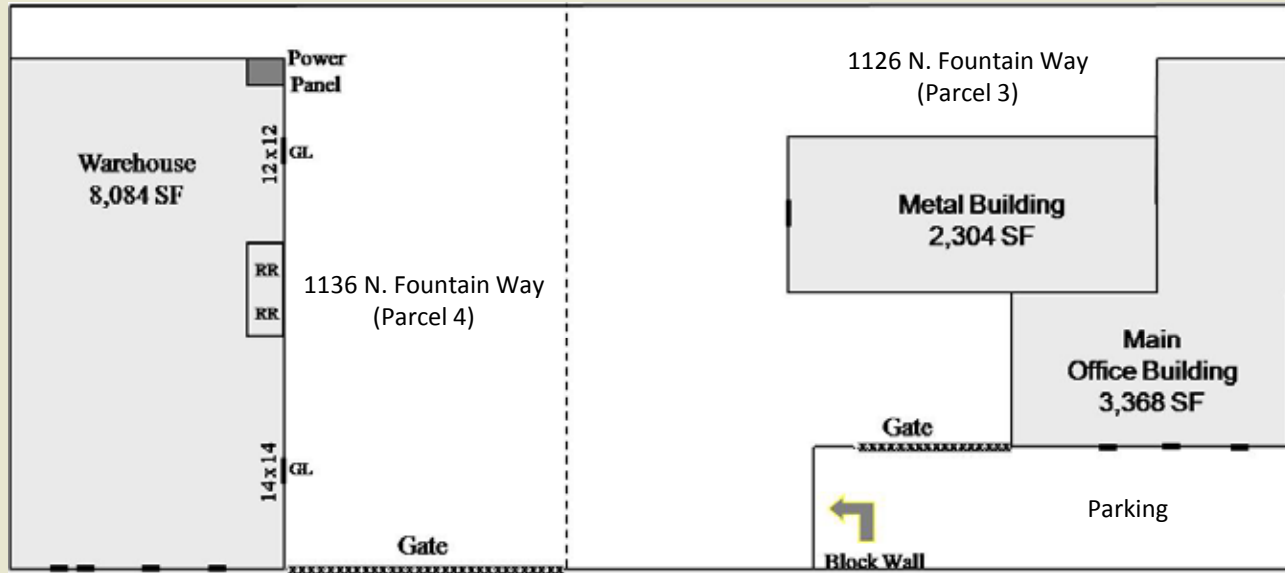

Approximate Building Size(s)

1126 N. Fountain Way (Parcel 3)	5,672 SF
1136 N. Fountain Way (Parcel 4)	8,084 SF
Total	13,756 SF

Approximate Land Area(s)

1126 N. Fountain Way (Parcel 3)	14,267 SF
1136 N. Fountain Way (Parcel 4)	14,813 SF
Total	29,080 SF

Corporate Neighbors

AT&T
B/E Aerospace, Inc.
Bank of America
Bunzl Distribution USA, Inc.
Kaiser Permanente
Konica Minolta Business Solutions
Manheim California
NBTY, Inc.
Pacific Sunwear of CA

Chris Migliori
714.385.1801 x-3020
chris.migliori@daumcommercial.com
CA License #00972843

Paul Gingrich
714.385.1801 x-3033
paul.gingrich@daumcommercial.com
CA License #01299770

DAUM
COMMERCIAL REAL ESTATE SERVICES
D/AQ Corp #01192558

Although all information is furnished regarding for sale, rental or financing is from sources deemed reliable, such information has not been verified and no express representation is made nor is any to be implied as to the accuracy thereof, and it is submitted subject to errors, omissions, changes of price, rental or other conditions, prior sale, lease or financing, or withdrawal without notice.