

For Sale

Frontage / Fenced Yard / Divisible

23,342 SF
Freestanding
Building



1801 Railroad St., Corona, CA

Features:

- Newer High Image Building
- **Divisible to 10,800 or 12,542 SF**
- Approximately 3,500 SF of Office (verify)
- Power 800 Amps/480 Volt (verify)
- Electrical Distribution
- Fully Fire Sprinklered
- Five (5) GL Doors
- Large Yard
- 20' Clearance
- Railroad Street Frontage
- Excellent Freeway Access
- 1.47 Acres of Land

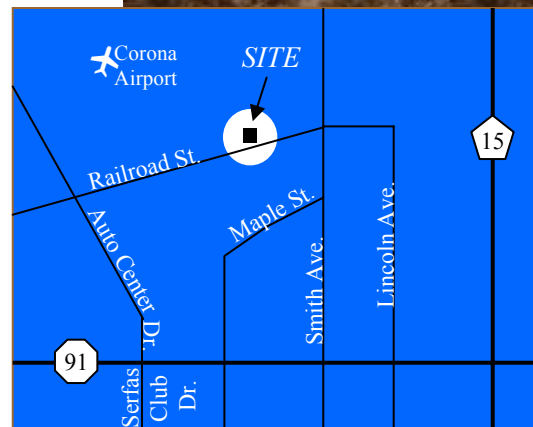

For further information, please contact:

Chris Migliori
(714) 385.1801

GVA DAUM
2300 E. Katella Ave. #100
Anaheim, CA 92806

chris.migliori@gvadaum.com



The information contained herein has been obtained from sources we deem reliable. While we have no reason to doubt it's accuracy, we do not guarantee it.

1801 Railroad St.

Site Plan

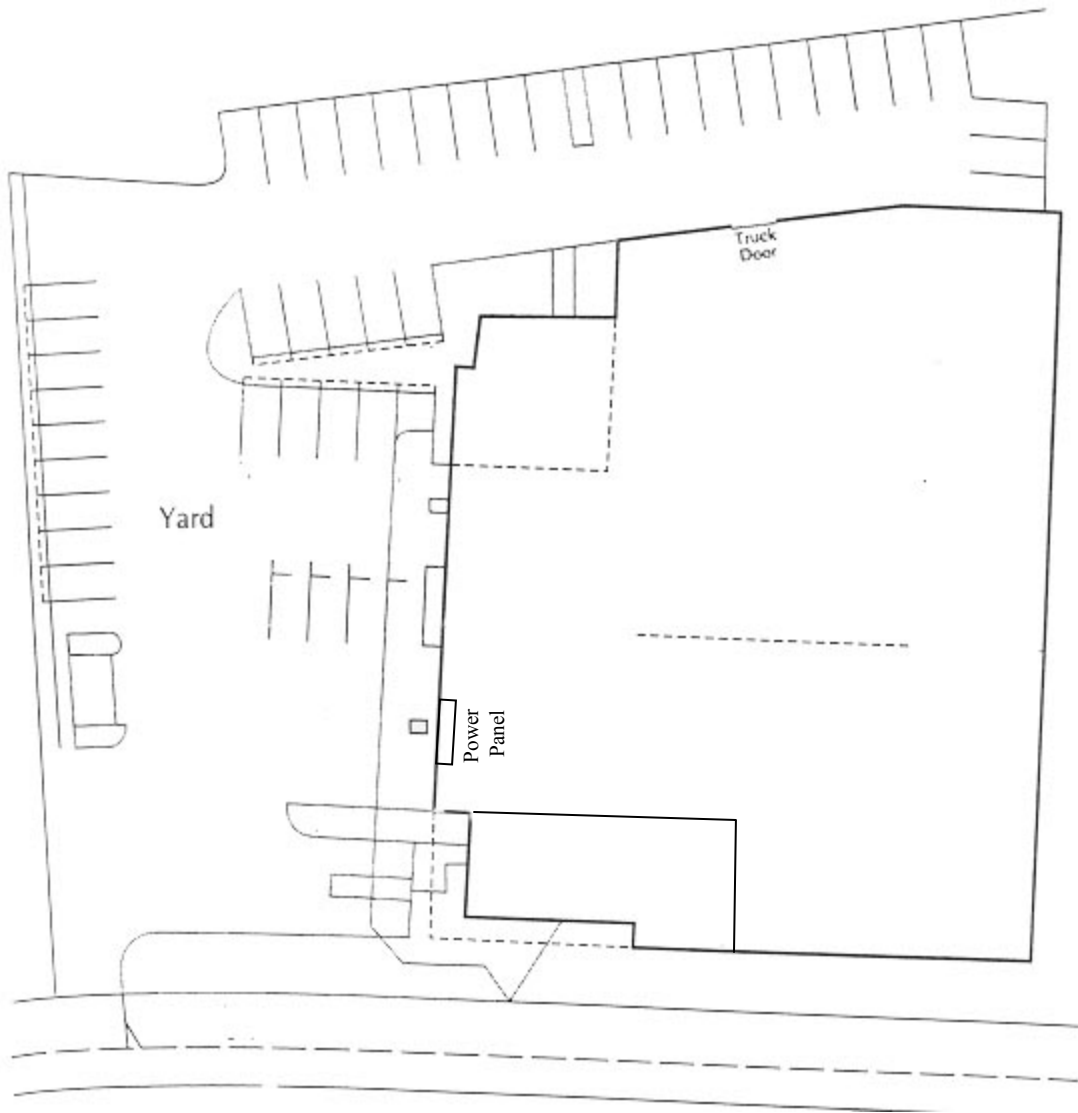

For further information, please contact:

Chris Migliori 

(714) 385.1801

chris.migliori@gvadaum.com

