

# FOR LEASE

# 31,410 SF



2740 E. Coronado Street | Anaheim, CA  
(Kraemer & La Palma)

## Building Features

- Freestanding Industrial Building
- 2,820 SF Of Office
- 3,000 Amps Power (verify)
- Three (3) GL Doors
- 18' Clear Height
- Fully Fire Sprinklered
- Three (3) Restrooms
- Rehab In Progress
- 24 Hour Security
- Adjacent To Recycling Center
- Excellent Freeway Access



## Chris Migliori, SIOR

Executive Vice President

714.385.1801 x-3020

chris.migliori@daumcommercial.com



COMMERCIAL REAL ESTATE SERVICES  
ONCOR INTERNATIONAL

2300 East Katella Avenue, Suite 100 | Anaheim, CA | 92806  
Phone 714.385.1801 | fax 714.385.1975 |

Although all information is furnished regarding for sale, rental or financing is from sources deemed reliable, such information has not been verified and no express representation is made nor is any to be implied as to the accuracy thereof, and it is submitted subject to errors, omissions, changes of price, rental or other conditions, prior sale, lease or financing, or withdrawal without notice.

# FOR LEASE

# 31,410 SF

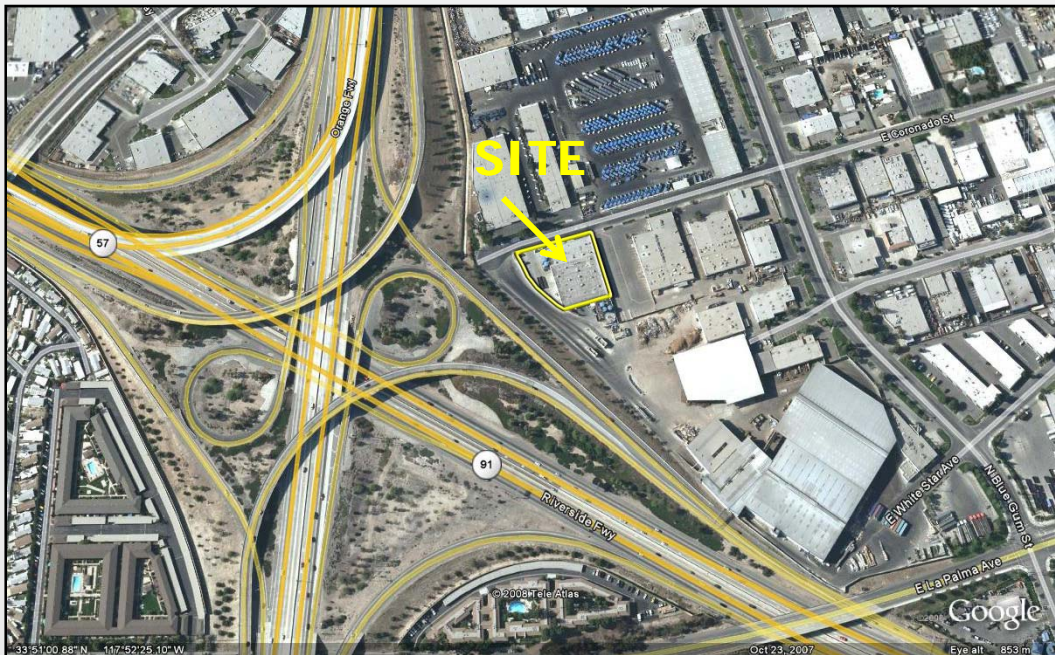
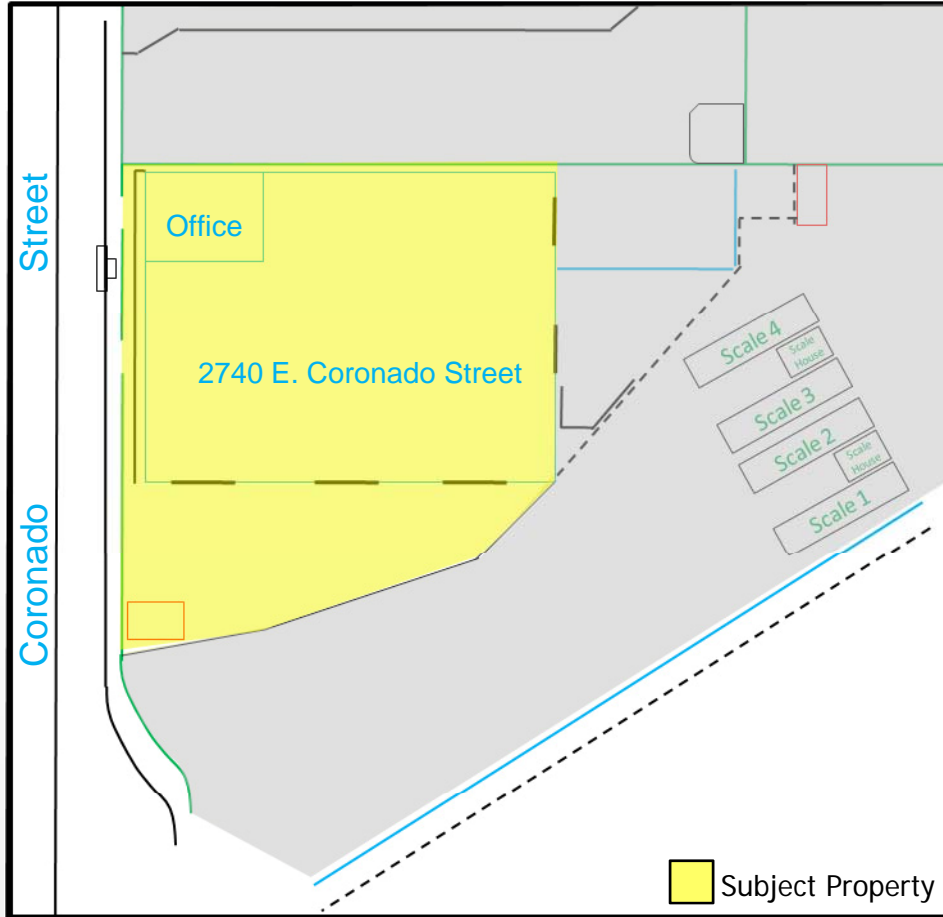

Although all information is furnished regarding for sale, rental or financing is from sources deemed reliable, such information has not been verified and no express representation is made nor is any to be implied as to the accuracy thereof, and it is submitted subject to errors, omissions, changes of price, rental or other conditions, prior sale, lease or financing, or withdrawal without notice.